

Licensing Act 2003 Premises Licence



Environmental Health & Trading Standards
Licensing Unit
Hub 2, 3rd Floor
PO Box 64529
London, SE1P 5LX

Premises licence number

849435

Part 1 - Premises details

Postal address of premises, or if none, ordnance survey map reference or description	
Thai Silk Railway Arches 94 To 95 Joan Street London SE1 8DA Ordnance survey map reference (if applicable), 180062531570	
Post town London	Post code SE1 8DA
Telephone number 020 7928 5111	

Where the licence is time limited the dates

Licensable activities authorised by the licence

Films - Indoors
 Live Music - Indoors
 Recorded Music - Indoors
 Performance of Dance - Indoors
 Entertainment Similar to live/recorded music - Indoors
 Late Night Refreshment - Indoors
 Sale by retail of alcohol to be consumed on premises
 Sale by retail of alcohol to be consumed off premises

The opening hours of the premises

For any non standard timings see **Annex 2**

Monday	09:00 - 03:00
Tuesday	09:00 - 03:00
Wednesday	09:00 - 03:00
Thursday	09:00 - 03:00
Friday	09:00 - 03:00
Saturday	09:00 - 03:00
Sunday	09:00 - 03:00

Where the licence authorises supplies of alcohol whether these are on and/ or off supplies

Sale by retail of alcohol to be consumed on premises

Sale by retail of alcohol to be consumed off premises

The times the licence authorises the carrying out of licensable activities

For any non standard timings see Annex 2 of the full premises licence

Films - Indoors

Monday	09:00 - 00:00
Tuesday	09:00 - 00:00
Wednesday	09:00 - 00:00
Thursday	09:00 - 00:00
Friday	09:00 - 00:00
Saturday	09:00 - 00:00
Sunday	09:00 - 00:00

Live Music - Indoors

Monday	11:00 - 03:00
Tuesday	11:00 - 03:00
Wednesday	11:00 - 03:00
Thursday	11:00 - 03:00
Friday	11:00 - 03:00
Saturday	11:00 - 03:00
Sunday	11:00 - 03:00

Recorded Music - Indoors

Monday	09:00 - 03:00
Tuesday	09:00 - 03:00
Wednesday	09:00 - 03:00
Thursday	09:00 - 03:00
Friday	09:00 - 03:00
Saturday	09:00 - 03:00
Sunday	09:00 - 03:00

Performance of Dance - Indoors

Monday	11:00 - 23:00
Tuesday	11:00 - 23:00
Wednesday	11:00 - 23:00
Thursday	11:00 - 23:00
Friday	11:00 - 23:00
Saturday	11:00 - 23:00
Sunday	11:00 - 23:00

Entertainment Similar to live/recorded music - Indoors

Monday	09:00 - 03:00
Tuesday	09:00 - 03:00
Wednesday	09:00 - 03:00
Thursday	09:00 - 03:00
Friday	09:00 - 03:00
Saturday	09:00 - 03:00
Sunday	09:00 - 03:00

Late Night Refreshment - Indoors

Monday	23:00 - 03:00
Tuesday	23:00 - 03:00
Wednesday	23:00 - 03:00
Thursday	23:00 - 03:00
Friday	23:00 - 03:00
Saturday	23:00 - 03:00
Sunday	23:00 - 03:00

Sale by retail of alcohol to be consumed on premises

Monday	09:00 - 03:00
Tuesday	09:00 - 03:00
Wednesday	09:00 - 03:00
Thursday	09:00 - 03:00
Friday	09:00 - 03:00
Saturday	09:00 - 03:00
Sunday	09:00 - 03:00

Sale by retail of alcohol to be consumed off premises

Monday	09:00 - 00:00
Tuesday	09:00 - 00:00
Wednesday	09:00 - 00:00
Thursday	09:00 - 00:00
Friday	09:00 - 00:00
Saturday	09:00 - 00:00
Sunday	09:00 - 00:00

Part 2

Name, (registered) address, telephone number and email (where relevant) of holder of premises licence

Soho Palace Limited
Alliance House
2nd Floor
29-30 High Holborn
London
WC1V 6AZ

Registered number of holder, for example company number, charity number (where applicable)

08295405

Name, address and telephone number of designated premises supervisor where the premises licence authorises for the supply of alcohol

Kah Kit Yap

[REDACTED]
[REDACTED]
[REDACTED]
[REDACTED]
[REDACTED]

Personal licence number and issuing authority of personal licence held by designated premises supervisor where the premises licence authorises for the supply of alcohol

Licence No. LN/000007196
Authority L.B Haringey

Licence Issue date 11/08/2015

[REDACTED]
Anti-Social Behaviour, Noise Nuisance &
Licensing Manager
Hub 2, 3rd Floor
PO Box 64529
London, SE1P 5LX
020 7525 5748
licensing@southwark.gov.uk

Annex 1 - Mandatory conditions

100 No supply of alcohol may be made under the Premises Licence -

- a. At a time when there is no Designated Premises Supervisor in respect of the Premises Licence; or
- b. At a time when the Designated Premises Supervisor does not hold a Personal Licence or his Personal Licence is suspended.

101 Every supply of alcohol under the Premises Licence must be made, or authorised by, a person who holds a Personal Licence.

107 Any individual carrying out security activities at the premises must be licensed by the Security Industry Authority. This does not apply where the premises are being used primarily as a Qualifying Club under a Club Premises Certificate, under a Temporary Event Notice, or primarily as a cinema, restaurant or theatre.

491 1. A relevant person shall ensure that no alcohol is sold or supplied for consumption on or off the premises for a price which is less than the permitted price.

2. For the purpose of the condition set out in paragraph (1):

(a) "duty" is to be construed in accordance with the Alcoholic Liquor Duties Act 1979;

(b) "permitted price" is the price found by applying the formula $P = D + (D \times V)$, where-

(i) P is the permitted price,

(ii) D is the amount of duty chargeable in relation to the alcohol as if the duty were charged on the date of the sale or supply of the alcohol, and

(iii) V is the rate of value added tax chargeable in relation to the alcohol as if the value added tax were charged on the date of the sale or supply of the alcohol;

(c) "relevant person" means, in relation to premises in respect of which there is in force a premises licence -

(i) the holder of the premises licence:

(ii) the designated premises supervisor (if any) in respect of such a licence; or

(iii) the personal licence holder who makes or authorises a supply of alcohol under such a licence;

(iv) "relevant person" means, in relation to premises in respect of which there is in force a club premises certificate, any member or officer of the club present on the premises in a capacity which enables the member or officer to prevent the supply in question; and

(v) "value added tax" means value added tax charged in accordance with the Value Added Tax Act 1994.

3. Where the permitted price given by paragraph (b) of paragraph 2 would (apart from this paragraph) not be a whole number of pennies, the price given by that sub-paragraph shall be taken to be the price actually given by that sub-paragraph rounded up to the nearest penny.

4. (1) Sub-paragraph (2) applies where the permitted price given by paragraph (b) of paragraph 2 on a day ("the first day") would be different from the permitted price on the next day ("the second day") as a result of a change to the rate of duty or value added tax;

(2) the permitted price which would apply on the first day applies to sales or supplies of alcohol which take place before the expiry of the period of 14 days beginning on the second day.

Annex 2 - Conditions consistent with the operating Schedule

136 Suitable beverages other than intoxicating liquor (including drinking water) shall be equally available for consumption with or otherwise as an ancillary to meals supplied in the premises.

288 That the CCTV system installed upon the premises shall be maintained in good working condition and operable at all times.

289 That recordings taken by the CCTV system installed upon the premises shall be kept and made available for inspection by authorised officers for a period of thirty one (31) days.

340 That SIA registered Door Supervisors will be employed on Saturday evenings after 2000 hours until the premises close and such registered Door Supervisors shall use all reasonable endeavours to prevent disorder within and outside the premises.

341 That the premises shall have an evacuation procedure the contents of which shall be made familiar to all staff and records kept of staff names and dates trained.

311 That notices shall be displayed at all doors to the premises requesting that customers leave the premises in a quiet and orderly manner.

342 That regular parameter checks around the premises for noise escape or noisy patrons, and measures to be taken when there is noise escape, or noisy patron.

343 That restriction shall be put on the use of the outside area after 23:00 hours.

344 That the attendees of private parties and functions are directed by a competent member of staff to the rear entrance of the premises when leaving the event beyond the hour of (00.00) 12 midnight.

345 That customers are asked or encouraged by competent staff not to drink on the external parts of the restaurant beyond 11pm on Thursday, Friday and Saturday evenings.

346 That the licensee or agent prevent localised nuisance that originated from the Thai Restaurant premises.

347 The volume of music after 23:00 hours will be reduced to a level that does not go beyond the premises.

348 Alcohol will not be served to persons under 21.

Annex 3 - Conditions attached after a hearing by the licensing authority

Annex 4 - Plans - Attached

Licence No. 849435

Plan No. (00) 118

Plan Date 14/03/06

LIGHTING KEY

- A ANTI CORROSIVE ENCLOSED FLUORESCENTS
- Aa STANDARD FLUORESCENTS (1500mm twin)
- B EMERGENCY BULKHEAD LIGHT
- Be EMERGENCY EXIT ILLUMINATED SIGN
- C 28 watt 2D light
- Ce 28 watt 2D light emergency
- D LV DOWNLIGHT Aurora DLL 317 (WC area in white) 80mm cut out. Vinto light to Disabled WC.
- De LV DOWNLIGHT Aurora DLL 317 (WC area white emergency)
- H LV DOWNLIGHT - ADJUSTABLE TO 90 DEGREES Aurora DLL314 113mm cut out
- J LV DOWNLIGHT Aurora DLL 317 (satin silver) low voltage lights. 80mm cut out
- K Vinto wall lights 415mm (E=emergency)
- Sounder/strobe for Disabled WC alarm

FIRE REQUIREMENTS:

- CEILING MOUNTED SMOKE DETECTOR
- SMOKE DETECTOR IN VOID
- CEILING MOUNTED HEAT DETECTOR (RATE OF RISE)
- CALL POINT
- SOUNDER

FIRE FIGHTING EQUIPMENT:

- FIRE BLANKET
- FIRE EXTINGUISHER: CD = CARBON DIOXIDE TYPE
D = DRY POWDER TYPE
W = WATER TYPE
F = FOAM TYPE
C = CHEMICAL TYPE

GENERAL:

- FIRE EXITS
- ENTRY (P=PUBLIC; S=STAFF)

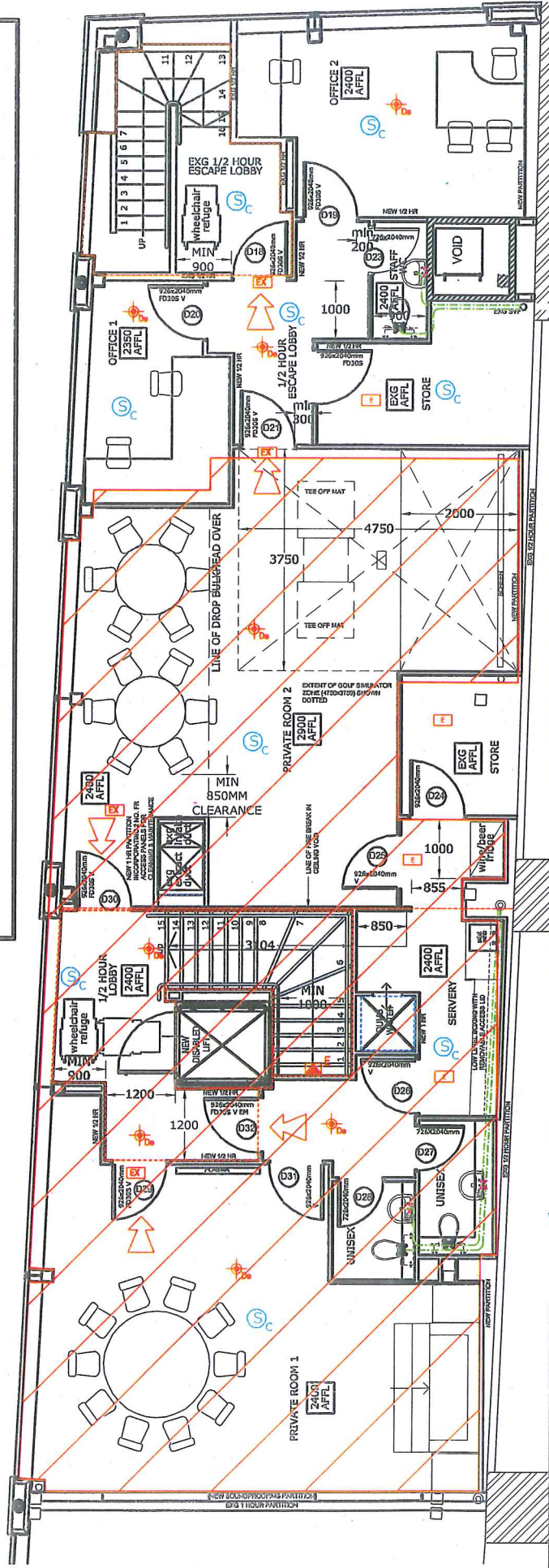

The copyright in this drawing is vested in Whittaker Prestidge Architects Ltd and may not be reproduced in any form without prior written consent. This drawing is to be read in conjunction with all other drawings and information issued for the contract. All discrepancies should be reported to WPA immediately. Written dimensions take precedence over scaled dimensions. Nothing shown, noted or referred to on this drawing confers or purports to confer on any third party, any benefit or right under The Contracts (Rights of Third Parties) Act 1999.

NOTES

- 1 HOUR COMPARTMENT
- 1/2 HOUR COMPARTMENT

DOORS:
 FD30S DENOTES 1/2 HOUR RATED DOORSET FITTED WITH COMBINED INTUMESCENT/SMOKE SEAL
 'V' DENOTES DOOR FITTED WITH VISION PANEL, FIRE RATED AS REQUIRED
 'EM' DENOTES DOOR FITTED WITH HOLD OPEN ELECTRO MAGNETIC DEVICE

REVISION _____ DATE _____

whittakerprestidgearchitects
 0 Basset Court, Newport Pagnell, Buckinghamshire MK16 0JN
 T 01908 211033
 F 01908 217373
 E wpa@wparchitects.co.uk

CLIENT MR N LEE	
PROJECT THAI SILK RESTAURANT & BAR	
TITLE PHASE 2 LICENSING ARRANGEMENT - MEZZANINE	
SCALE 1:50@A2 1:100@A4	DATE 20.06.06 DRAWN BY AJL CHECKED BY KP
PROJECT 0616	ZONE LEVEL 105

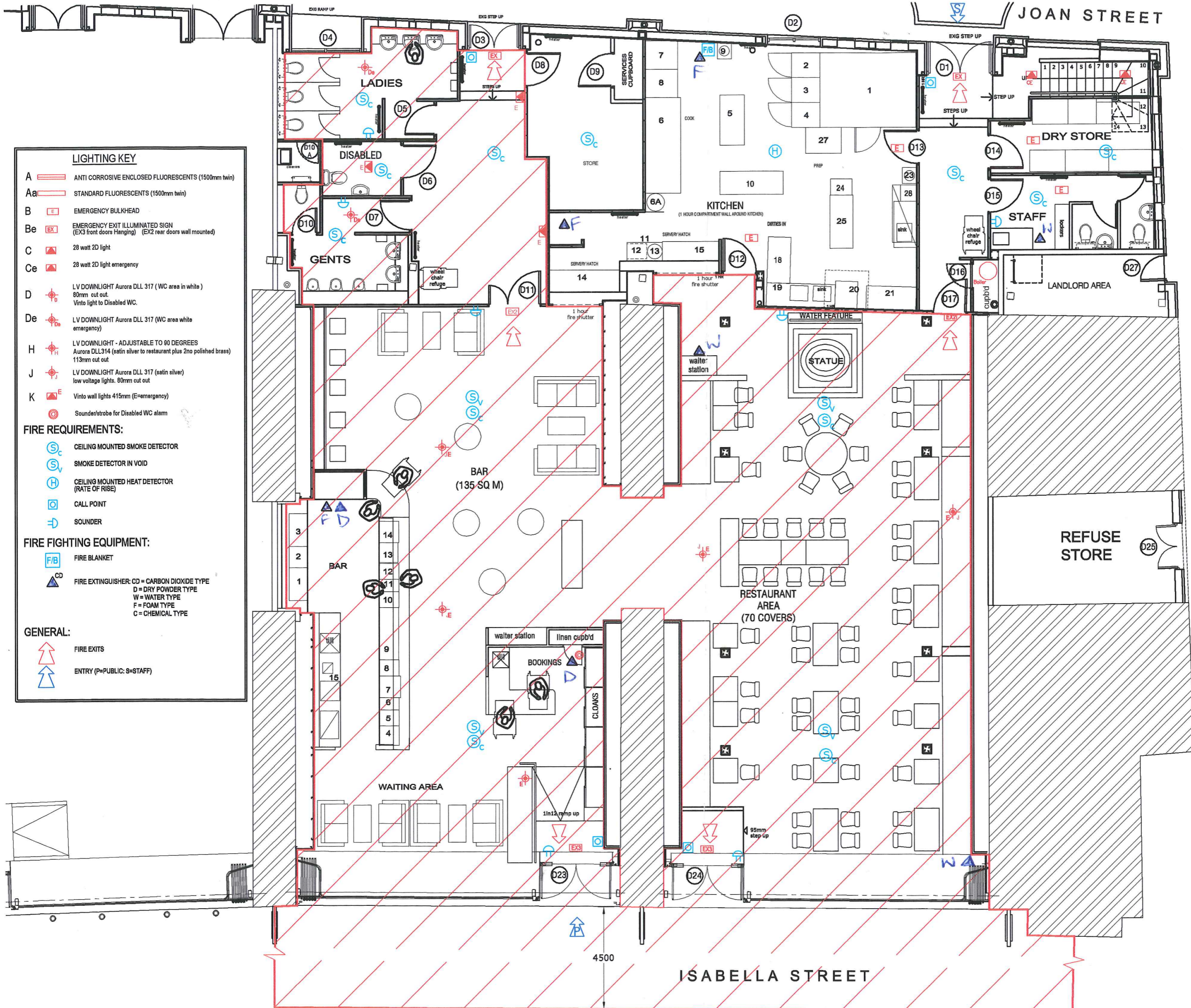

- LIGHTING KEY**
- A ANTI CORROSIVE ENCLOSED FLUORESCENTS (1500mm twin)
 - Aa STANDARD FLUORESCENTS (1500mm twin)
 - B EMERGENCY BULKHEAD
 - Be EMERGENCY EXIT ILLUMINATED SIGN (EX3 front doors Hanging) (EX2 rear doors wall mounted)
 - C 28 watt 2D light
 - Ce 28 watt 2D light emergency
 - D LV DOWNLIGHT Aurora DLL 317 (WC area in white) 80mm cut out. Vinto light to Disabled WC.
 - De LV DOWNLIGHT Aurora DLL 317 (WC area white emergency)
 - H LV DOWNLIGHT - ADJUSTABLE TO 90 DEGREES Aurora DLL314 (satin silver to restaurant plus 2no polished brass) 113mm cut out
 - J LV DOWNLIGHT Aurora DLL 317 (satin silver) low voltage lights. 80mm cut out
 - K Vinto wall lights 415mm (E=emergency)
 - Sounder/strobe for Disabled WC alarm
- FIRE REQUIREMENTS:**
- CEILING MOUNTED SMOKE DETECTOR
 - SMOKE DETECTOR IN VOID
 - CEILING MOUNTED HEAT DETECTOR (RATE OF RISE)
 - CALL POINT
 - SOUNDER
- FIRE FIGHTING EQUIPMENT:**
- FIRE BLANKET
 - FIRE EXTINGUISHER: CD = CARBON DIOXIDE TYPE
D = DRY POWDER TYPE
W = WATER TYPE
F = FOAM TYPE
C = CHEMICAL TYPE
- GENERAL:**
- FIRE EXITS
 - ENTRY (P=PUBLIC; S=STAFF)

The copyright in this drawing is vested in Whittaker Prestidge Architects Ltd and may not be reproduced in any form without prior written consent. This drawing is to be read in conjunction with all other drawings and information issued for the contract. All discrepancies should be reported to WPA immediately. Written dimensions take precedence over scaled dimensions. Nothing shown, noted or referred to on this drawing confirms or purports to confer on any third party, any benefit or right under The Contracts (Rights of Third Parties) Act 1999. NOTES

REVISION	DATE

wpa
whittakerprestidgearchitects
6 Bassett Court, Newport Pagnell, Buckinghamshire MK16 0JN
T 01908 211033
F 01908 217378
E wpa@wparchitects.co.uk

CLIENT MR N LEE		
PROJECT THAI SILK RESTAURANT & BAR 94/95 JOAN/ISABELLA STREET SE1 8DA		
TITLE PHASE 1 LICENSING ARRANGEMENT PLAN		
SCALE 1:50@A1 1:100@A3	DATE 14.03.06	
PROJECT ZONE LEVEL DRG NO REVISION 0438 (00) 118	DRAWN BY AJL	CHECKED BY KP